

New OXIBD/A Radio Receiver Module

OPERATORS: 936, 1050, and SmartCNX™ controllers

DATE: 09/15/2020

SUBJECT: New OXIBD/A Radio Receiver Modules

SUBJECT DESCRIPTION:

New OXIBD/A radio receiver module is replacing the older OXI/A.

IMPACT:

The new OXIBD/A radio receiver module now features direct antenna connections, a re-located program button & LED, and a different color. The new OXIBD/A is backward compatible with all Inti and Era One transmitters and control boards and all functions remain the same.

Figure 1 shows the differences between the old and new OXI radio receiver modules. If replacing an OXI/A with an OXIBD/A, the antenna connection will need to be moved from the control board and wired to the OXIBD/A as shown in Figure 2, below.

The newer OXIBD/A modules are inserted into the control boards the same way as the older OXI/A modules.

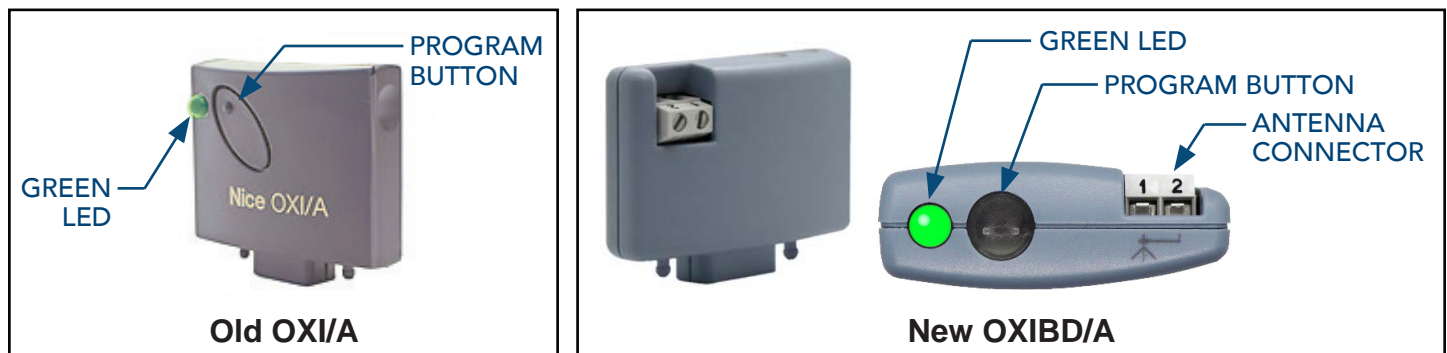

FIGURE 1: Old and New OXI Radio Receiver Modules

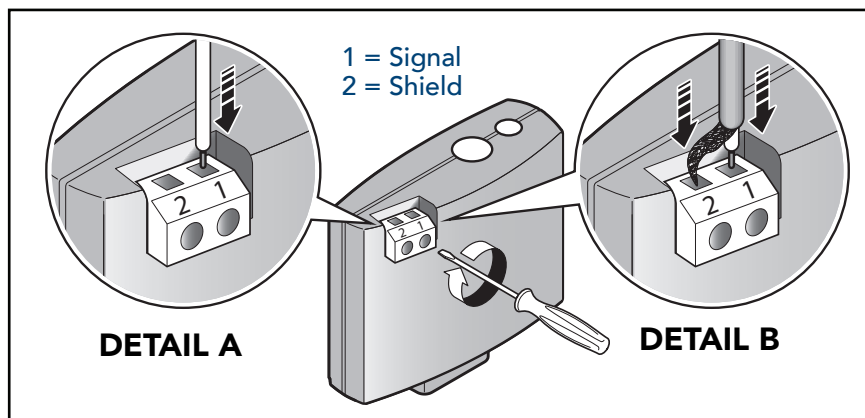

FIGURE 2: New OXIBD/A Radio Antenna Installation